



**57 Chesterfield Avenue, Gedling, Nottingham,
Nottinghamshire NG4 4GE**

£1,200 pcm

Tel: 0115 9680268



- Beautiful Home
- council tax band B
- Amazing views
- Three Story House
- 4 Bedroom Family Home
- Available now

The property benefits from a versatile layout comprising of;

Entrance hall , double bedroom/ study, a spacious living room and dining room, modern kitchen and bathroom.

The property can be unfurnished or furnished.

To the front of the property is a driveway providing off street parking and to the rear outdoor space complete with patio area.

Situated in Gedling close to local amenities and with views of Gedling country Park.

Regular transport links to the City Centre. Fantastic primary and secondary schools are near by.

This property has so much to offer and will not be available for long. Perfect family home! £1200 PCM

Council Tax Band: B

Parking options: Driveway, Off Street

Garden details: Rear Garden



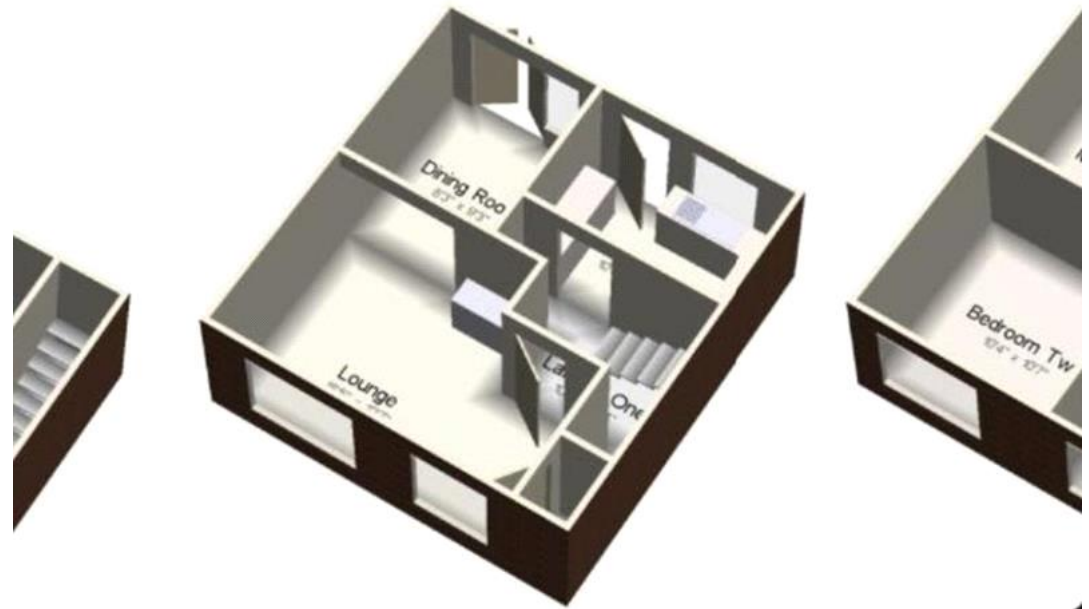

Ground Floor

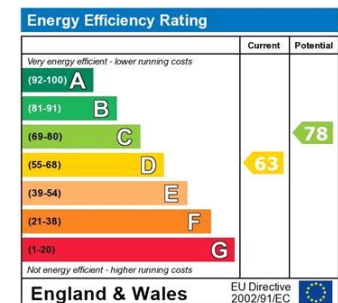

The energy efficiency rating is a measure of the overall efficiency of a home. The higher the rating the more energy efficient the home is and the lower the fuel bills will be.

Viewing by appointment only
 JMS Sales & Lettings
 32 High Street, Hucknall, Nottingham, Nottinghamshire NG15 7HD
 Tel: 0115 9680268 Email: enquiries@jmslettings.co.uk Website: www.jmslettings.co.uk

